

SMDA-200 & SMDA-400 Individual Components

SMDA safety door drives are suitable for use in machines from a wide range of industries and can be mounted in any position. Both SMDA models are available as individual components, the SMDA-400 additionally in a box version.

In the **individual version**, the drive and control unit can be installed separately.

DRIVE

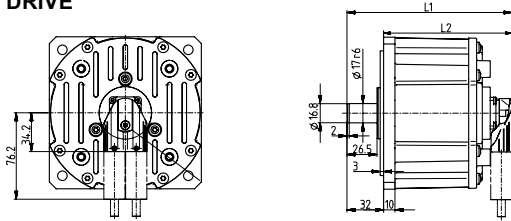

CONTROL UNIT

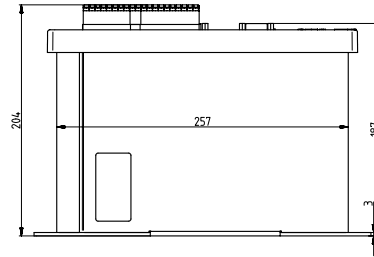
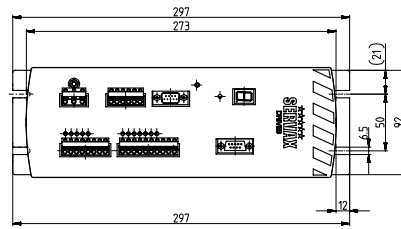

Technical Data

Model		SMDA-200	SMDA-400
Door weight	kg	≤ 260	200 – 750
Tensile force	N	230	400
Traverse path	m	≤ 8.0	≤ 8.0
Max. traverse speed	m/s	1.0	1.0
Motor data			
Motor technology		16-pole permanent magnetic direct drive	
Nominal motor torque	Nm	3.1	5.4
Motor pulse torque	Nm	6.0	9.8
Nominal speed at nominal torque	min ⁻¹	335	270
Overall length L1	mm	145.5	169
Installation depth L2	mm	113.5	137
Motor weight	kg	3.9	5.3
Mounting position		any	any
Motor voltage	VAC	17	22
Protection class		IP54	IP54
Control data			
Max. power consumption	W	190	310
Mains voltage	VAC	115/230/400	115/230/400
Mains frequency	Hz	50/60	50/60
Ambient operating temperature	°C	+ 10 ... + 40	+ 10 ... + 40
Relative humidity	%	15 ... 85	15 ... 85
Protection class		IP20	IP20
Digital I/O	VDC	24	24
Ports		– 7 galvanically isolated control inputs – 5 galvanically isolated control outputs – 1 RS-232 configuration interface – 1 motor power connector – 1 motor encoder connection – 1 mains connection 115/230/400 VAC	
Preconfigured input functions		AUTO mode, open, close	
Selectable input functions		2nd drive profile, reduced open, reference switch, external sensors	
Output functions		door referenced, door closed, door open, error, obstacle detected	
Housing dimensions (H × W × D)	mm	297 × 92 × 187	